

Paradox[®] 9

Developer's Edition



Feature Guide

July 1999

Copyright © 1999 Corel Corporation. All rights reserved.

This feature guide is a preliminary document and may be amended considerably prior to the ensuing product release. Product specifications, pricing, packaging, technical support and information ("Specifications") refer to the United States retail English version only. The United States retail version is only available within North America and is not for export. Specifications for all other versions (including language versions and versions available outside of North America) may vary. All specifications, claims, features, representations and/or comparisons provided are correct to the best knowledge of Corel as of the date of publication, but are subject to change without notice;

INFORMATION IS PROVIDED BY COREL ON AN "AS IS" BASIS, WITHOUT ANY OTHER WARRANTIES OR CONDITIONS, EXPRESS OR IMPLIED, INCLUDING BUT NOT LIMITED TO, WARRANTIES OF MERCHANTABILITY, SATISFACTORY QUALITY, MERCHANTABILITY OR FITNESS FOR A PARTICULAR PURPOSE, OR THOSE ARISING BY LAW, STATUTE, USAGE OF TRADE, COURSE OF DEALING OR OTHERWISE. THE ENTIRE RISK AS TO THE RESULTS OF THE INFORMATION RECEIVED IS ASSUMED BY YOU. WE SHALL HAVE NO LIABILITY TO YOU OR ANY OTHER PERSON OR ENTITY FOR ANY INDIRECT, INCIDENTAL, SPECIAL, OR CONSEQUENTIAL DAMAGES WHATSOEVER, INCLUDING, BUT NOT LIMITED TO, LOSS OF REVENUE OR PROFIT, LOST OR DAMAGED DATA OR OTHER COMMERCIAL OR ECONOMIC LOSS, EVEN IF WE HAVE BEEN ADVISED OF THE POSSIBILITY OF SUCH DAMAGES, OR THEY ARE FORESEEABLE. WE ARE ALSO NOT RESPONSIBLE FOR CLAIMS BY A THIRD PARTY. OUR MAXIMUM AGGREGATE LIABILITY TO YOU AND THAT OF OUR DEALERS AND SUPPLIERS SHALL NOT EXCEED FORTY DOLLARS CANADIAN(\$40.00CDN). SOME STATES/COUNTRIES DO NOT ALLOW THE EXCLUSION OR LIMITATION OF LIABILITY FOR CONSEQUENTIAL OR INCIDENTAL DAMAGES, SO THE ABOVE LIMITATIONS MAY NOT APPLY TO YOU.

Published July 1999

Corel, CorelDRAW, jPdox, ObjectPAL, Paradox, Quattro, and WordPerfect are trademarks or registered trademarks of Corel Corporation or Corel Corporation Limited.

Adobe and Acrobat are registered trademarks of Adobe Systems, Inc.

Borland and InterBase are registered trademarks of Inprise Corporation.

Java, JavaBeans, and JDBC are trademarks of Sun Microsystems, Inc.

JRun is a registered trademark of Live Software.

Linux is a registered trademark of Linus Torvalds.

Macintosh and Power Macintosh are registered trademarks of Apple Computer, Inc.

Microsoft, ActiveX, FoxPro, Visual Basic, Windows, and Windows NT are trademarks or registered trademarks of Microsoft Corporation.

Sybase is a registered trademark of Sybase, Inc.

UNIX is a registered trademark of The Open Group.

All other fonts, names, and logos are trademarks or registered trademarks of their respective companies.

Table of Contents

Corel Corporate Profile	4
Executive Summary	5
What is Paradox 9 Developer's Edition?	6
Introducing Paradox 9 Developer's Edition	8
Why Choose Paradox 9 Developer's Edition?	11
Paradox 9 Developer's Edition at Work	15
Where Do I Get More Information?	17

Corel Corporate Profile

Corel Corporation is an internationally recognized developer of award-winning graphics and business productivity applications. Since its foundation in 1985, Corel has developed products known for excellence and value that target emerging trends in the software industry. Committed to value, compatibility, choice, and open standards, Corel develops products for Windows®, Macintosh®, UNIX®, Linux®, and Java™ platforms. Corel is renowned for its comprehensive, competitively priced products that have powerful core applications and value-added utilities. Corel develops market-leading products, such as the CorelDRAW® suite of graphics applications and the WordPerfect® suite of business tools, and continues to meet the demands of the corporate, retail, and academic markets.

In 1992, Corel introduced the first graphics suite to coincide with the launch of Microsoft® Windows 3.0. CorelDRAW 3, a competitively priced, all-in-one graphics solution, established the company as a world leader in graphics software. In 1995, CorelDRAW 6 was released as the first major 32-bit application available for Windows 95. Keeping its commitment to cross-platform solutions, Corel released CorelDRAW for Power Macintosh® in 1998. The expanding CorelDRAW product line continues to attract industry recognition, winning more than 300 first-place international awards.

In 1996, Corel broadened its focus when it acquired the renowned WordPerfect family of business applications. Corel carefully re-engineered this world-class software into a market-leading line of powerful productivity applications. In 1997, Corel partnered with Dragon Systems, Inc. to deliver Corel® WordPerfect® Suite 8 with Dragon NaturallySpeaking™, a large vocabulary, general purpose, continuous speech recognition system. Continuing its commitment to performance, compatibility and value, Corel is focused on developing office applications that are compatible with other off-the-shelf office suites. In addition, Corel is continually expanding to increase the presence of WordPerfect worldwide. To help meet the growing needs of international users, Corel partnered with Philips Electronics N.V. in March 1999 to introduce PHILIPS FreeSpeech 2000 in international versions of WordPerfect Office 2000.

Corel is headquartered in Ottawa, Canada. Corel's products ship in over 17 languages through a network of more than 160 distributors in 70 countries. Corel maintains several offices throughout Canada and the United States. In addition, Corel has offices in over 18 countries worldwide. Corel's common stock trades on the NASDAQ Stock MarketSM under the symbol CORL and on the Toronto Stock Exchange under the symbol COR.

For more information, visit Corel's Web site at www.corel.com.

Executive Summary

Growth in office suite sales has introduced desktop databases to a variety of users. Desktop databases must now meet the needs of new and experienced database users, and database developers.

For new users, desktop databases must be easy to use. Desktop databases must also include powerful development tools to let developers create databases that can manage expanding volumes of data.

Paradox® 9 Developer's Edition is a database solution for experienced Paradox users. Developers can create cost-effective customized database applications, a front-end client to back-end database, or a database for a Web site.

The Paradox development team has enhanced Paradox in four main areas: performance and productivity, compatibility, connectivity capabilities, and Java™ Internet features.

The performance and productivity features in Paradox 9 Developer's Edition assist developers in creating Paradox applications quickly and efficiently. Enhanced Table dialog boxes let developers access common database tasks. Paradox 9 also incorporates visual tools, such as the Visual Database Designer, to create and modify tables and table links; and the enhanced Visual Query Builder. Also included in Paradox 9 Developer's Edition are Paradox 9 Runtime and the enhanced Paradox 9 Distribution Expert (PDE).

Compatibility features have made it easier for developers to transfer data between business applications, such as Microsoft® Excel and Microsoft® Access. Also, because Paradox 9 is backward compatible, developers who built applications in previous versions of Paradox can preserve their investments. Files created in an earlier Windows version of Paradox can be used in Paradox 9.

With the addition of Borland® SQL Links, native connections to most back-end databases such as Oracle®, Informix, and the Microsoft SQL Server can be made easily. The MERANT DataDirect™ ODBC Paradox 9 driver enables data sharing between different database applications. Paradox 9 Developer's Edition also includes PeerDirect™ Replication Engine 3.5 software, which lets remote users update central databases without requiring a dedicated connection.

The new Java Internet features let developers design database-based Web sites. The new Paradox Web Form Designer lets users build dynamic Web forms in a Java environment. The Java Internet features also let users publish dynamic HTML documents to a Web page from a Paradox 9 table or report.

What is Paradox® 9 Developer's Edition?

Paradox 9 is an easy-to-use relational database application that helps users manage data. Users can store data in different ways, and create professional forms, charts, and reports in which to display data. Paradox 9 can run as a standalone system on one computer, or as a multiuser system on a network.

Paradox 9 Developer's Edition provides more experienced Paradox users with tools to create, maintain, and distribute Paradox 9 databases.

The applications, tools, and features distributed with Paradox 9 Developer's Edition include:

- Paradox 9
- Paradox 9 Runtime
- jPdox™ Web Utilities¹
- Paradox 9 Distribution Expert (PDE)
- Borland SQL Links
- MERANT DataDirect ODBC Paradox Driver
- PeerDirect Replication Engine 3.5 Software
- JRun™²
- Paradox JDBC Driver
- comprehensive user manuals and other documentation

Minimum System Requirements

- Windows 95, Windows 98, or Windows NT® 4.0
- 486/66 DX
- 16 MB RAM (32 MB RAM recommended)
- 65 MB hard disk space (196 MB with Paradox 9 Runtime and Paradox 9 Distribution Expert)
- CD-ROM drive
- VGA monitor or better

1 See Paradox 9 Internet Features White Paper for more information.

2 See Paradox 9 Internet Features White Paper for more information.

Paradox Product History

Paradox is an award-winning Windows-based database originally developed by Ansa Software in 1985. It was purchased by Borland International, Inc. in 1987. Through a previous alliance between Borland and Corel, Paradox was included in with Corel® Office Professional 7.

In 1996, Corel licensed Paradox from Borland. This perpetual license gives Corel exclusive distribution rights for Paradox. Corel has assumed responsibility for the development, marketing, sales, and support of Paradox worldwide. In July 1997, Corel updated Paradox and released Corel Paradox 8. Paradox 9 continues to offer users performance, compatibility, and value.

Introducing Paradox® 9 Developer's Edition

Paradox 9 Developer's Edition comes with the standard applications, tools, and features that are found in other versions of Paradox 9, such as the standalone edition. However, other powerful elements specifically for development tasks are included.

The following applications, supporting products and tools, and documentation are included with Paradox 9 Developer's Edition:

Main Applications

Paradox 9: Paradox 9 lets users create databases, retrieve data, and generate reports using one of the many Experts available, or through custom methods.

Paradox 9 Runtime: Paradox 9 Runtime is a shell for running applications developed using Paradox 9 and ObjectPAL. Paradox 9 Runtime lets developers deploy customized database applications that include toolbars, pop-up menus, and multiuser capabilities. It also lets users display and print reports.

Paradox 9 Distribution Expert (PDE): Paradox 9 Distribution Expert (PDE) is designed for intermediate to advanced Paradox users, including beginner developers. The PDE packages a developer's Paradox application files, Paradox 9 Runtime, and the Borland Database Engine into a single setup that end users can install.

jPdox™ Web Utilities

Many organizations are moving from document-based Web sites to database-based Web sites. The jPdox Web Utilities are advanced features of Paradox 9 that provide users with an Internet or intranet solution. These utilities help users design and publish forms, tables, and reports to intranets or the Internet.

Paradox Web Form Designer: The Paradox Web Form Designer lets users design and create forms using embedded JavaBeans™, eliminating the need to write code. Java™ Applets embedded in HTML files help users create platform-independent Web forms. Users can share current data from a Web site that is associated with a Paradox-compliant database, or a database that has a JDBC driver. This application is WYSIWYG.

Paradox JDBC Driver: The Paradox JDBC Driver is used to connect databases. It gives users standard Structured Query Language (SQL) access to databases from Java programs, including the Paradox Web Form Designer. The Paradox JDBC Driver provides users with a direct connection to the Borland Database Engine (BDE), which provides access to most desktop and server-based databases from Java programs.

JDBC Proxy Server: The JDBC Proxy Server is a Java application that redirects all incoming and outgoing information between the JDBC Client and the JDBC Server. The JDBC Proxy Server also functions as a security barrier, since it acts as a monitor between the network server and the JDBC Server.

Paradox Report Server: The Paradox Report Server lets users create dynamic HTML documents using HTML Table Expert or HTML Report Expert. When the data in a Paradox database changes, the Web page is updated to reflect the changes. Users can also publish static HTML documents. This feature is compliant with standard Web servers that support Java servlets.

Corel Web Server: The Corel Web Server acts as an intermediary between Web browsers and compatible applications to transfer requests and responses between them. The Corel Web Server can be used in conjunction with another Web server to enhance Web server functionality, or to support dynamic data publishing.

JRun: JRun is a Java-based program that provides a report servlet to Paradox 9. This servlet responds to user requests for Web documents containing tables and reports dynamically created using Paradox 9.

Supporting Products and Tools

Borland Database Engine (BDE) 5.01: Paradox uses the Borland Database Engine (BDE) as its data access engine. The BDE provides users with a full set of database tools, which can be used to create simple and complex applications, order and inventory systems, event tracking, and human resource management.

Borland SQL Links 5.01: SQL is used by developers and advanced database users to perform network queries across different hardware and software platforms.

MERANT DataDirect ODBC Paradox Driver: The MERANT DataDirect ODBC Paradox Driver makes Paradox 9 compatible with other ODBC-compliant databases, such as Microsoft Access, Microsoft® FoxPro®, dBASE®, and Oracle.

Adobe® Acrobat® Reader 4.0: Adobe Acrobat Reader lets users view, navigate, and print Portable Document Format documents (PDFs) across multiple platforms. The Paradox 9 CD Reference Center (see Documentation, below) contains four files that are supplied in PDF format. Adobe Acrobat Reader must be installed in order to view these files.

PeerDirect Replication Engine 3.5 software: The PeerDirect Replication Engine 3.5 software is a database replication system that gives users fast, reliable access to database information at any time from any location.

Documentation

Paradox 9 User Guide: Paradox 9 includes comprehensive documentation that provides conceptual and procedural information. A detailed online Help system is also available. Two online tutorials guide users through the steps necessary to create databases and use ObjectPAL code.

Paradox 9 Power Programming: The Official Guide: *Paradox 9 Power Programming: The Official Guide*, written by Mike A. Prestwood, helps users understand the fundamentals of programming with Paradox 9. Prestwood has written five other books about computer programming, including *Paradox 7 Programming Unleashed*. This book uses examples and step-by-step instructions to explain the key components of programming with Paradox, including ObjectPAL, SQL, crosstabs, and database design.

jPdox Web Utilities User Guide: The jPdox Web Utilities User Guide provides users with information regarding the installation, configuration, and application of each of the jPdox Web Utilities included with Paradox 9.

Paradox 9 ObjectPAL Reference Guide: The Paradox 9 ObjectPAL Reference Guide is a two-volume reference to the ObjectPAL programming language. It describes the methods and procedures used in ObjectPAL and provides a list of all ObjectPAL constants and properties.

CD Reference Center: The CD Reference Center includes the following four resources for Paradox 9 users: the Paradox 9 User Guide, the Paradox 9 ObjectPAL Reference Guide, Release Notes, and the jPdox Web Utilities User Guide.

Why Choose Paradox® 9 Developer's Edition?

The tools and features available in Paradox 9 Developer's Edition streamline repetitive tasks, eliminate redundancy, and increase overall user productivity.

Open Standards

Paradox 9 Developer's Edition supports open standards. This means that developers can design an application that is not related to a specific technology, and therefore can use other vendors and drivers, such as SQL and ODBC.

SQL: Paradox 9 Developer's Edition is compatible with SQL. SQL is used by developers and advanced database users to perform network queries across different hardware and software platforms. It is one of the most popular methods of manipulating data in a relational database and is often embedded in general purpose programming languages, such as Delphi™, Microsoft® Visual Basic®, and C++. It supports the creation of Microsoft® SQL tables, and can function as a client for Oracle, InterBase®, and Sybase®/Microsoft SQL Server databases via an SQL Links connection. Paradox 9 uses Borland SQL Links.

Compatibility with SQL lets Paradox 9 Developer's Edition users communicate and share data with SQL-based databases without losing data when they open SQL tables in Paradox. In addition, users do not have to perform special procedures to convert data between Paradox and other SQL-based applications.

ODBC: ODBC is a Microsoft Windows service that lets Microsoft Windows applications access data through a common interface. Paradox 9 Developer's Edition ships with the MERANT DataDirect Paradox ODBC Driver.

JDBC™ Application Program Interface (API): The JDBC API is a standard data access interface, and a standard part of the Java 2 platform. The JDBC API defines Java classes to represent such database functions as SQL statements, database connections, and result sets.

Microsoft ActiveX®: Microsoft ActiveX controls are built by third parties in other programming languages, such as C++, that can be used directly in Paradox. They function in the same manner as native Paradox controls, such as fields or buttons. With ActiveX controls, users can extend the capabilities of Paradox to include customized features.

Integration, Compatibility, and Connectivity

Integration

Increasingly businesses are choosing 32-bit office suites, such as the WordPerfect Office 2000 Professional Edition. More users are exposed to desktop databases and the benefits of using this type of application in a business environment. Users require the database to integrate with the other core applications in the office suite. Paradox 9 has a consistent user interface with core applications in the WordPerfect Office 2000 Professional Edition. Integration with WordPerfect Office 2000 and the compatibility of Paradox 9

Developer's Edition let users transfer data between business and database applications, such as Microsoft Excel and Microsoft Access.

Publish reports to WordPerfect: Users can publish Paradox 9 reports to WordPerfect 9.

Enhanced Copy and Paste functionality: Users can copy and paste data from a Paradox 9 table to a Quattro Pro spreadsheet.

Integrated common toolbar: The Paradox 9 toolbar is common to the other applications in the WordPerfect Office 2000 Professional Edition.

Spell Checker: Paradox 9 lets users spell check data in edit and memo fields that appear in tables and forms.

Compatibility

Compatibility features ensure that Paradox 9 users can share data with different applications. Desktop database users demand that applications be both backward compatible and compatible with other business applications, such as Microsoft Access.

Backward and forward compatibility: Paradox 9 Developer's Edition is backward and forward compatible. Users can open files in Paradox 9 that were created with a previous Windows version of Paradox without losing data. Users can also open tables that were created in a previous version of Paradox without writing code or following special procedures. Likewise, files created in Paradox 9 can be used in previous versions of Paradox, such as Paradox 5.

Paradox 9 is also backward compatible with DOS versions of Paradox. Users can open tables that were created with DOS versions of Paradox in Paradox 9 without losing data. Forms, reports, and scripts must be converted before they can be used in a Windows environment.

Connectivity

Paradox 9 Developer's Edition lets users connect to other applications to enhance the capabilities of their database.

Borland SQL Links 5.01: SQL is used by developers and advanced database users to perform network queries across different hardware and software platforms. Borland SQL Links 5.01 lets users access data on an SQL server as if it were resident on the local computer. This connection gives Paradox access to a large database all the features and functions of database servers, including stored procedures and data dictionaries. Borland SQL Links 5.01 connects to the following databases: Oracle, Sybase, InterBase, Microsoft SQL Server, DB2, and Informix.

MERANT DataDirect ODBC Paradox Driver: The MERANT DataDirect ODBC Paradox Driver makes Paradox 9 compatible with other ODBC-compliant databases, such as Microsoft Access, Microsoft FoxPro, dBASE, and Oracle.

Powerful Application Development

The Paradox 9 Developer's Edition lets users customize database applications using the following tools and features:

Development Tools

The development tools in the Paradox 9 Developer's Edition let users design and deliver forms and reports.

ObjectPAL: ObjectPAL is an object-based, event-driven visual programming language. Users can use ObjectPAL to customize applications with new buttons, menus, dialog boxes, prompts, warnings, and online Help. ObjectPAL can be used to extend the regular functions of Paradox or to create non-database applications.

ObjectPAL supports variables, control structures, and many of the same data types as other programming languages. Developers can use the methods and procedures supplied by ObjectPAL, or create custom methods and procedures.

Create Table and Restructure Table dialog boxes: Paradox 9 tables can be created using the Create Table dialog box and restructured using the Restructure Table dialog box. Users can change a table's field name, field type, field order, key, indexes, validity checks, referential integrity, password protection, table language, and table lookups. Aspects of a table can be changed at any time, as long as forms and reports that use the table in their data model are not in use.

Data Model Designer: A data model is the graphical representation of the relationships between tables in Paradox 9. Data models can be based on single or multiple tables. Relationships between tables are defined by linking tables. The Data Model Designer is used to create data models based on tables, queries, or previously created data models. The data model is often used to support forms and reports.

Visual Database Designer: The Visual Database Designer helps users understand the basics of database design. Users can create Paradox tables, establish referential integrity between tables, view the table fields, and create, print, and save a layout of a database design. The relationships created between tables using the Visual Database Designer are saved in the table structure. The Visual Database Designer also links to the Create Table and Restructure Table dialog boxes.

User-Defined Forms and Reports: Users do not need to use preset templates to create Paradox 9 forms and reports. Paradox 9 provides users with a complete set of design tools to create fully customized forms and reports from a blank screen or from a simple design.

Object Explorer: The Object Explorer provides access to the ObjectPAL Editor window and lets users change an object's properties. The object tree of the Object Explorer displays a schematic diagram of a user's form or report design. The object tree shows users the design objects and their relationship to each other. The object tree is useful if a user has a large design and does not want to use the scroll bars to navigate the design.

SQL queries: The Borland SQL Links connection lets users query native Paradox and dBASE tables and remote SQL-based server databases. The new SQL Query Expert helps users in creating queries while writing SQL code in the background. However, developers who want to use direct SQL commands can use the SQL

Editor Window to type the SQL code. In addition to these tools, Paradox lets users create an SQL table or borrow an existing SQL table structure for use in a new Paradox table.

Visual Query Builder: The Visual Query Builder lets users create and execute SQL queries without typing code. When using the Visual Query Builder, the SQL Editor is open in the background, letting users view and edit SQL code as it appears in the editor. Users can create a full range of SQL queries.

Query By Example (QBE) queries: Users can query one or several tables to retrieve information. Paradox finds the records that meet the specified conditions and presents the results in an Answer table. Query definitions can be saved. Query By Example (QBE) is a popular query building method used in earlier versions of Paradox. To perform a QBE query, users give Paradox an example of the desired result. Selection conditions and example elements define the query.

Application Distribution and Replication

The application distribution and replication features of Paradox 9 Developer's Edition provide users with a cost and time saving solution. Developers can create, replicate, and distribute their database applications to a wide variety of users with the following tools and applications:

Paradox 9 Runtime: Paradox 9 Runtime is a shell for running applications developed using the full version of Paradox 9 and ObjectPAL. Paradox 9 Runtime lets developers create and implement customized database applications that include toolbars, pop-up menus, and multiuser capabilities. It also lets users display and print reports.

Paradox 9 Runtime is cost effective. Under the terms of the Paradox 9 license, developers cannot make copies of Paradox 9. However, developers can distribute copies of Paradox 9 Runtime with no licensing fees, provided they follow the terms of the Paradox 9 Runtime license agreement.

Note that the version of Paradox Runtime must match the version of Paradox used by the developer.

Paradox 9 Distribution Expert (PDE): The Paradox 9 Distribution Expert (PDE) is for intermediate to advanced Paradox users, including beginner developers. The PDE takes the user through a series of steps, helping with tasks such as setup options, choosing files for distribution, saving projects, and creating distributions. The following components are required to properly run the PDE and are shipped with Paradox 9: Paradox 9 Runtime, Borland Database Engine 5.01, and the WordPerfect Office 2000 writing tools.

PeerDirect Replication Engine 3.5 software: PeerDirect Replication Engine 3.5 software is a database replication system that gives users fast, reliable access to database information at any time. It supports replication across a supported database platform. Users can replicate Paradox databases directly, with other Paradox sites, or with any other database supported by PeerDirect, such as Oracle, Microsoft SQL Server, and Microsoft Access. Replication can be managed from anywhere in the network, including remote servers and laptop computers.

Paradox® 9 Developer's Edition at Work

The following scenario illustrates how the components of the Paradox 9 Developer's Edition work together. It is based on the business conducted by the sales team of a fictional software company.

Case Study

The sales team at a software company has an extensive list of contact and client information, including names, account numbers, addresses, phone numbers, and fax numbers. This list is stored in the company's main database server, which could be an Oracle, Microsoft SQL Server, Informix, or similar server.

Local users with a full installation of Paradox 9 Developer's Edition can access the database directly using Borland SQL Links. They can read, edit, and update the client information in the central shared database, giving all users immediate access to new data.

On some occasions, a salesperson must fax information to a client using a fax program. The fax program uses the MERANT DataDirect ODBC Paradox 9 driver to access the database and retrieve the client's fax number.

When salespeople travel, each uses a laptop computer. Since hard disk space is limited on these computers, the employees use a database application that was built in Paradox 9 and installed using the Paradox 9 Distribution Expert (PDE). The application runs in Paradox 9 Runtime. Each employee also has a copy of portions of the company's client database, contained in Paradox 9 tables, that the application can update directly. Each evening, the salespeople connect to the company through a modem link, then make changes to the database by using the PeerDirect Replication Engine 3.5 software.

At the company's headquarters, the sales team must make specific information available to their clients over the Internet. They publish dynamic HTML reports in Paradox 9, and use the JRun servlet runner to interface with their existing Web server. Feedback from clients is obtained over the Internet through a Web form. The Web forms are created with the Paradox Web Form Designer, then set up on the company's Web server using the Paradox JDBC Proxy Server.

The following graphic illustrates how the components of Paradox 9 Developer's Edition work together.

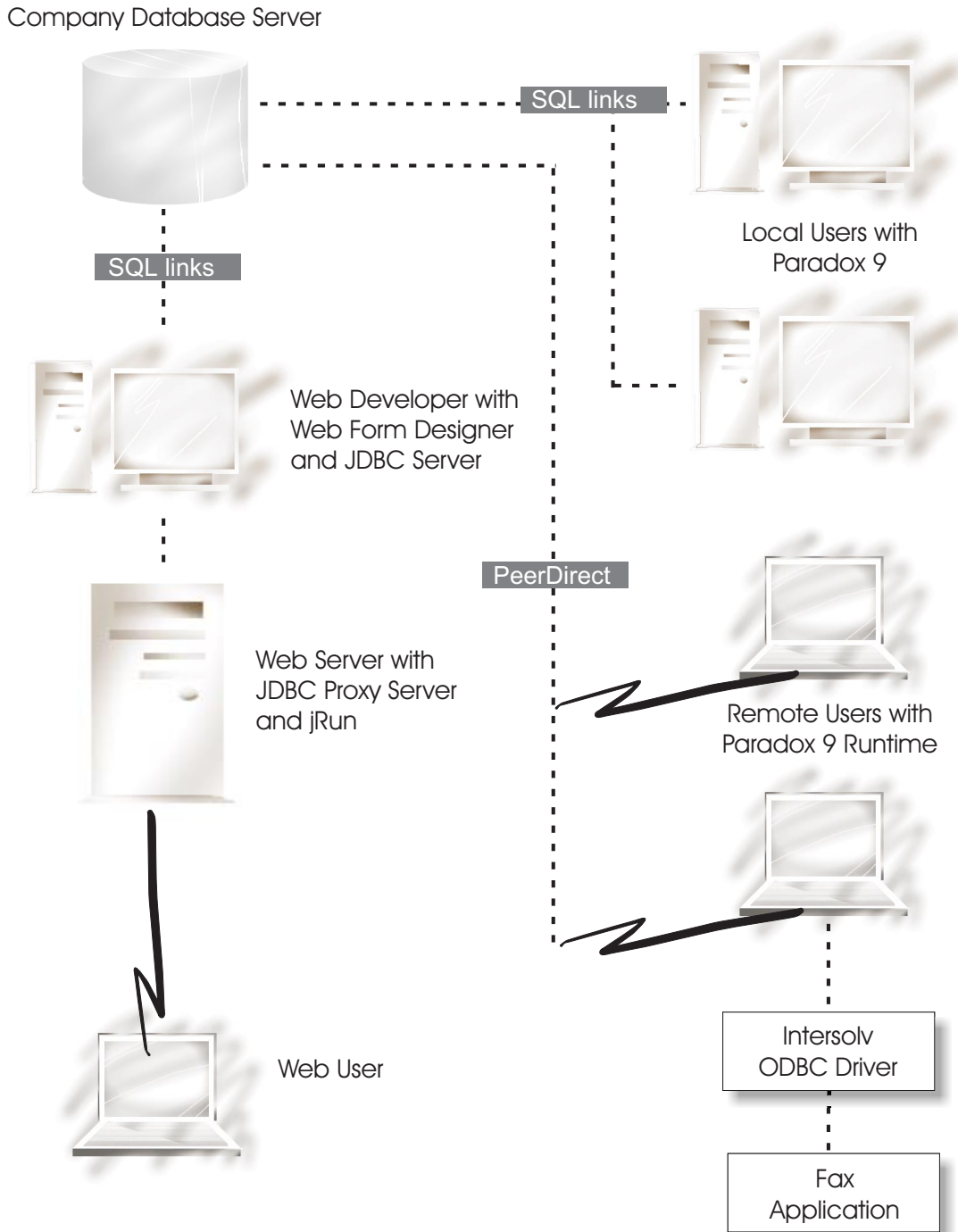

Where Do I Get More Information?

Corel Corporate Headquarters

1600 Carling Avenue

Ottawa, Ontario

CANADA

K1Z 8R7

Telephone: (613) 728-8200

For **general media inquiries**, contact Corel's media relations department at

Email: media@corel.ca

For **reader contact information**, contact Corel's customer service department at

Telephone: 1-800-77-COREL

For information about **Corel's Year 2000 Policy**, visit our Web site at www.corel.com/2000.htm or email Year2000c@corel.ca.